

Worth County Federal Aid Structure Inventory

S T A T E O F M I N N E S O T A

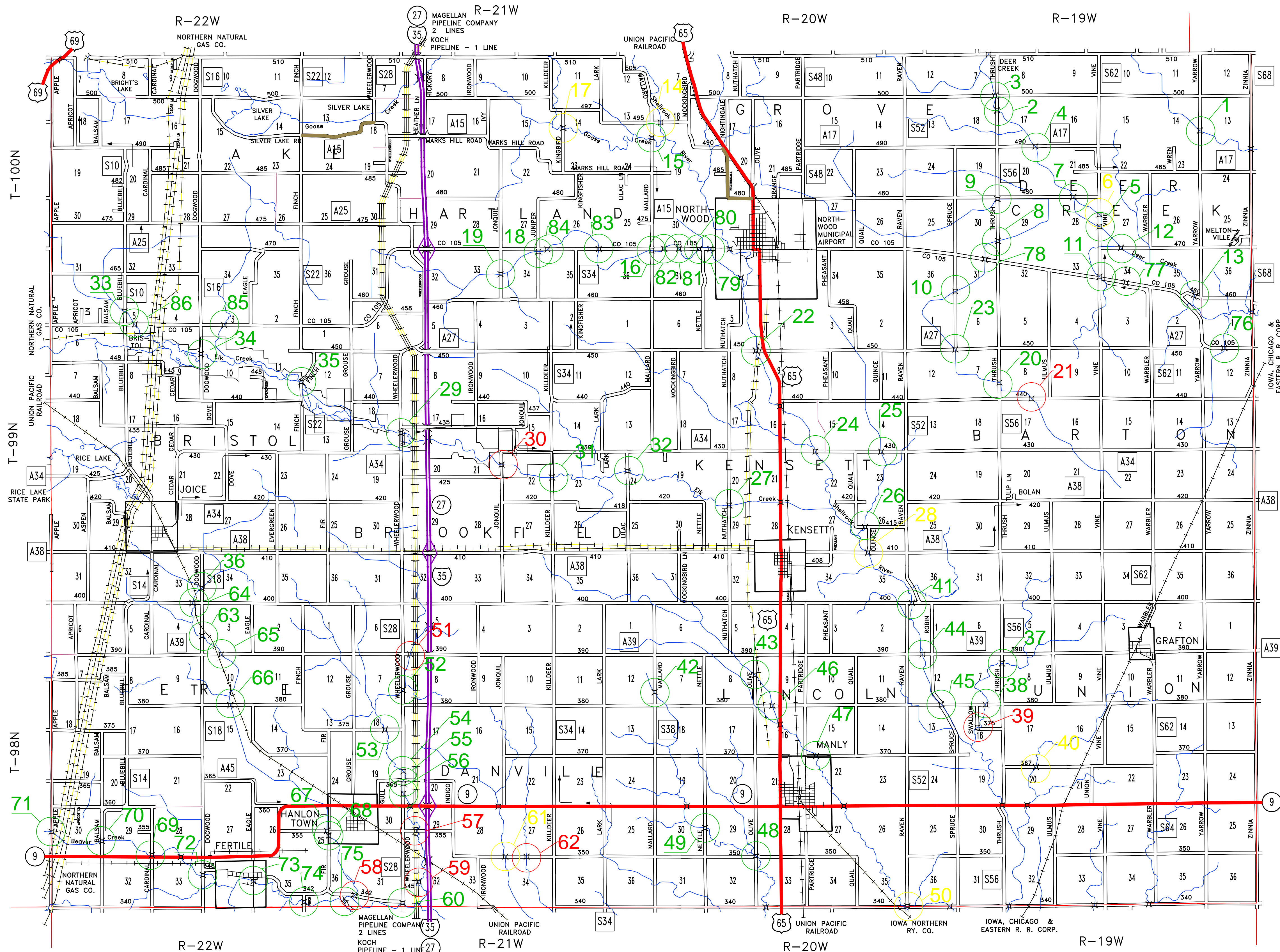

- | | |
|----------------------------|--------------------|
| 1 Triple Rail Pipe | 61 Bridge One Lane |
| 2 Bridge | 62 Bridge 11_18_20 |
| 3 Bridge | 63 Bridge |
| 4 Bridge | 64 Rail Pipe |
| 5 Bridge | 65 Bridge |
| 6 Bridge Narrow | 66 Bridge |
| 7 Bridge | 67 Bridge |
| 8 Bridge | 68 Box |
| 9 Bridge | 69 Corr. Pipe |
| 10 Bridge | 70 Bridge |
| 11 Bridge | 71 Box |
| 12 Bridge | 72 Bridge |
| 13 Bridge | 73 Bridge |
| 14 Bridge One Lane | 74 Bridge |
| 15 Box | 75 Bridge |
| 16 Bridge | 76 54210 Bridge |
| 17 Bridge Narrow | 77 Box |
| 18 Rail Pipe | 78 Bridge |
| 19 Rail Pipe | 79 54170 Bridge |
| 20 Culvert | 80 54160 Bridge |
| 21 Bridge 25_37_40 | 81 54150 Bridge |
| 22 Bridge | 82 54140 Bridge |
| 23 Bridge | 83 54130 Bridge |
| 24 Bridge | 84 54120 Bridge |
| 25 Bridge | 85 54110 Bridge |
| 26 Bridge | 86 54100 Bridge |
| 27 Bridge | |
| 28 Bridge One Lane | |
| 29 Corr. Pipe | |
| 30 Bridge 24_37_38 | |
| 31 Bridge | |
| 32 Bridge | |
| 33 Bridge | |
| 34 Bridge | |
| 35 Box | |
| 36 Bridge | |
| 37 Bridge | |
| 38 Corr. Arch | |
| 39 Bridge 7_11_13 | |
| 40 Bridge One Lane | |
| 41 Bridge | |
| 42 Box | |
| 43 Twin 10'x6' PCCB | |
| 44 Bridge | |
| 45 Bridge | |
| 46 Bridge | |
| 47 Bridge | |
| 48 Bridge | |
| 49 Bridge | |
| 50 Bridge One Lane | |
| 51 Bridge 16_26_27 | |
| 52 Corr. Pipe | |
| 53 Bridge | |
| 54 Bridge | |
| 55 Bridge | |
| 56 Bridge | |
| 57 Bridge Closed | |
| 58 Bridge 9_15_9 | |
| 59 Bridge Remvd. frm. inv. | |
| 60 Bridge | |